

DATE	SYM	REVISION DESCRIPTION	ECN	DRN
3-12	A	RELEASED FOR PRODUCTION	I2N025	TH

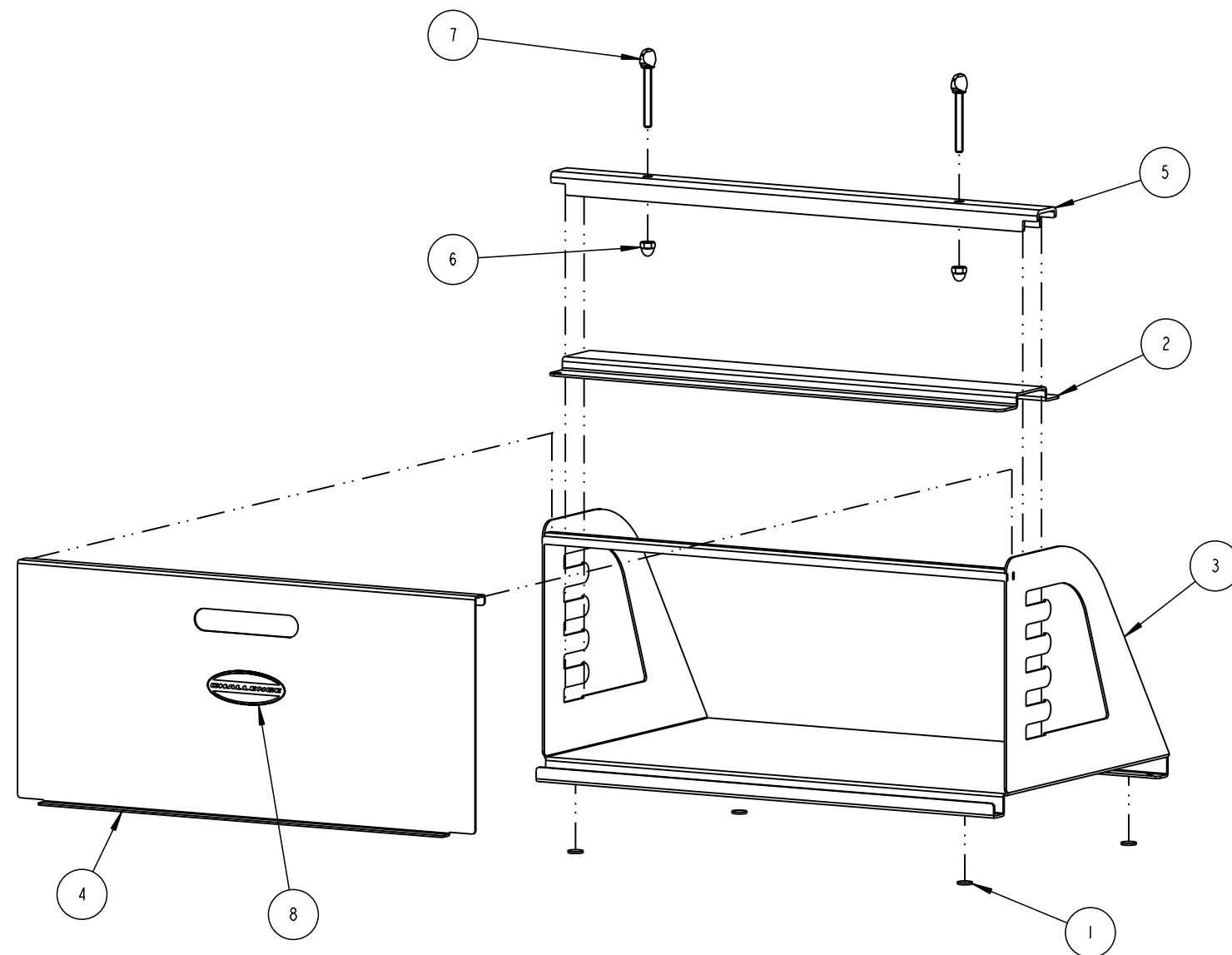

NO.	PART NO.	DESCRIPTION	QTY
1	41074	POLYURETHANE DOT	4
2	65010	CLAMP	1
3	65526	FRAME	1
4	65527	DOOR	1
5	65528	CLAMPING BRACKET	1
6	H-6432-4	NUT - 1/4-20 ACORN NYLON	2
7	H-6955-416	THUMBSCREW - 1/4-20 X 2"	2
8	S-1076-2	CHALLENGE LABEL	1

### ASSEMBLY INSTRUCTIONS:

1. PEEL AND STICK RUBBER FEET (ITEM #1) ONTO BOTTOM CORNERS OF FRAME (ITEM #3).
2. INSERT THUMBSCREWS (ITEM #7) INTO CLAMPING BRACKET (ITEM #5) AND TURN SCREWS PART WAY DOWN.
3. SCREW NYLON ACORN NUTS (ITEM #6) ONTO THUMBSCREWS AND TIGHTEN.
4. PEEL AND STICK CHALLENGE LABEL (ITEM #8) ONTO FRONT OF DOOR (ITEM #4).

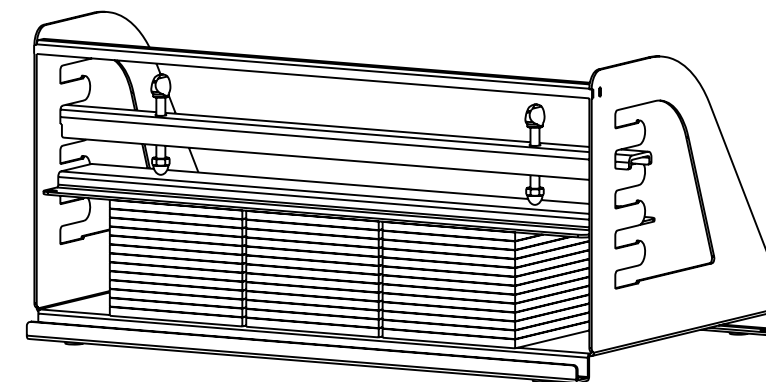
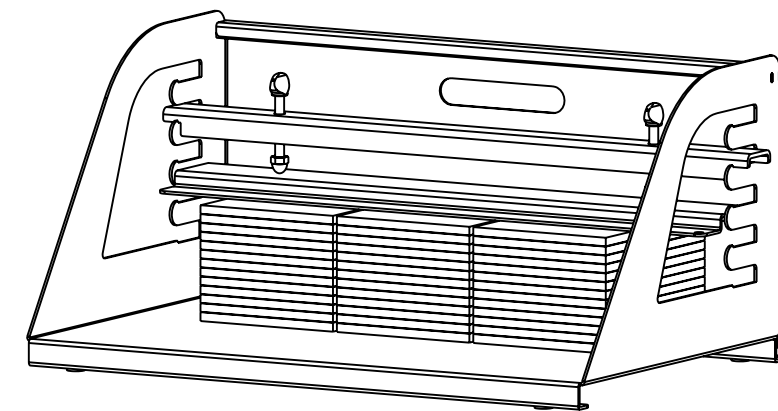

### OPERATING INSTRUCTIONS:

1. HANG THE DOOR (ITEM #4) ON THE UPPER CROSS BAR OF THE FRAME (ITEM #3), MAKING SURE THE BOTTOM OF THE DOOR IS SEATED IN THE LOWER CHANNEL OF THE FRAME.
2. STACK THE PAPER READY TO BE PADDED IN THE FRAME, WITH THE SIDE TO BE PADDED PRESSED FIRMLY AGAINST THE DOOR AND THE PILES CENTERED IN THE FRAME.
3. LAY THE CLAMP (ITEM #2) ON TOP OF THE PILES, WITH ONE EDGE OF THE CLAMP UP TIGHT AGAINST THE DOOR.
4. POSITION THE CLAMPING BRACKET (ITEM #5) INTO THE LOWEST POSSIBLE SET OF GROOVES THAT STILL ALLOW IT TO FIT ABOVE THE CLAMP. THE THUMBSCREWS MAY HAVE TO BE UNSCREWED A LITTLE PRIOR TO DOING THIS.
5. TIGHTEN THE CLAMP ON THE PAPER BY TURNING BOTH THUMBSCREWS SIMULTANEOUSLY. DO NOT OVER-TIGHTEN.
6. REMOVE THE DOOR BY LIFTING IT UP AND OFF THE FRAME.
7. LIGHTLY BRUSH ON PADDING COMPOUND ON THE EDGES TO BE PADDED. TWO LIGHT COATS WILL WORK BETTER THAN ONE HEAVY COAT.
8. ONCE THE PADDING COMPOUND HAS DRIED COMPLETELY, UNSCREW THE THUMBSCREWS, REMOVE THE CLAMP, THEN REMOVE THE PADS FROM THE FRAME.

## THE CHALLENGE MACHINERY COMPANY

6125 Norton Center Drive, Norton Shores, MI 49441 - Phone: 231-799-8484 - Fax: 231-798-1275

THIS DRAWING IS THE PROPERTY OF THE CHALLENGE MACHINERY CO. PURSUANT TO LIMITED LICENSE RIGHTS, AND IT IS LOANED WITHOUT OTHER CONSIDERATION THAN THE AGREEMENT AND CONDITION THAT IT IS NOT TO BE REPRODUCED, COPIED OR OTHERWISE DISPOSED OF DIRECTLY OR INDIRECTLY AND IS NOT TO BE USED IN WHOLE OR IN PART TO ASSIST IN MAKING, OR TO FURNISH ANY INFORMATION FOR MAKING OF UNAUTHORIZED DRAWINGS, AND PRINTS, APPARATUS OR PARTS THEREOF. THE ACCEPTANCE OF THIS DRAWING WILL BE CONSTRUED AS AN ACCEPTANCE ADMISSION OF THE FOREGOING CONDITIONS AND AN ACKNOWLEDGEMENT THAT THIS DRAWING IS SUBJECT TO IMMEDIATE RETURN UPON DEMAND.

DRAWING IS IN ACCORDANCE WITH ASME Y14.5M-1994	MATERIAL: ASSEMBLY	MACHINE: TABLE-TOP PADDER	
	STOCK SIZE: -	USED IN: -	
<b>TOLERANCES</b> (UNLESS OTHERWISE SPECIFIED) 0/0 ±1/32 .00 ±.01 .000 ±.005 .0000 ±.0005 ANGULAR ±F	FINISH: N/A	DRAWN BY: TH	CHECKED BY: MW
	WEIGHT (lbs): -	DATE: 5-10-12	DATE: 5-10-12
ALL HOLES, SLOTS, THREADS, ETC. ARE TO BE $\perp$ WITHIN .005 OF PLACEMENT SURFACE	NAME: <b>TABLE-TOP PADDER</b>		
ALL RIGHT-ANGLE BENDS, CORNERS, ETC. ARE TO BE 90°±1°	PART NO: <b>65525</b>	SHEET	REV
DE-BURR SHARP EDGES UNLESS NOTED		<b>1 OF 1</b>	<b>A</b>